

ELECTRICAL INPUTS

Power Supply	90-264 VAC (10A Fused Input)
Operating Current	1A/120 VAC or 0.5A/240 VAC
Input Frequency	47-63 Hz
Overvoltage	Category II
Solar Panel Input Voltage	12-19 VDC
Solar Panel Input Current	1.74 ADC

ENVIRONMENTAL CONDITIONS

Operating Temperature	-40°F - 149°F (-40°C - 65°C)
Operating Humidity	1A/120 VAC or 0.5A/240 VAC
Environment Sealing	IP6X
Maximum Altitude	9842.52 ft. (3000 m)
Pollution Degree	2
Solar Panel Input Current	1.74 ADC

PHYSICAL

Dimensions	11.8x6.1x14.2 in (300x155x360 mm)
Weight	11 lbs. (5 kg.)
Input (Power)	DIN AC Power
Input (Configuration)	USB-C
Input (Communications)	Sim Card Slot (Micro SIM)
Intended Use	Indoor/Outdoor

PHYSICAL DESCRIPTION

Control Box	Includes a RF antenna, GPS antenna and communication units which vary between system configurations.
Service Box	Includes the backup battery, power supply unit, micro-SIM card slot and maintenance USB-C socket connector.
Solar Panel	<ul style="list-style-type: none"> Enables the CAU to operate using solar energy in case there is no available connection to the power grid or electricity outage. Available as an optional configuration.
Backup Battery	<ul style="list-style-type: none"> Used as a backup power source. Enables temporary CAU operation during main power outages.
Power Supply	Converts 220 or 110 VAC from the power grid to low internal DC voltages used by the CAU electronics.
Mounting Adapter	Enables to install the CAU on a wall or a pole.

CAU-1 Electrical Connectors

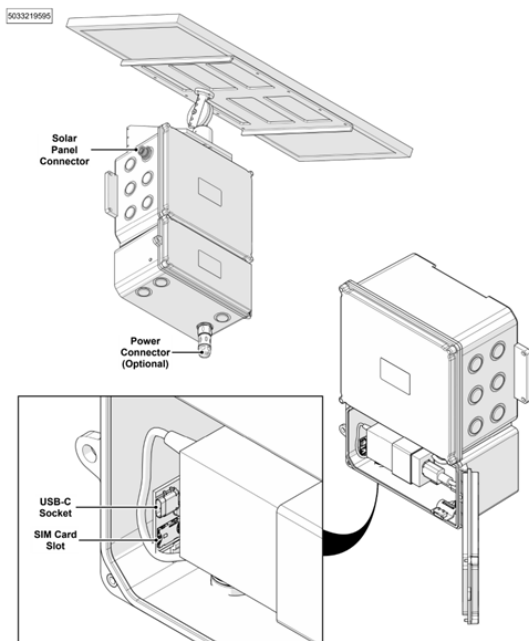

CAU-1 Physical Description

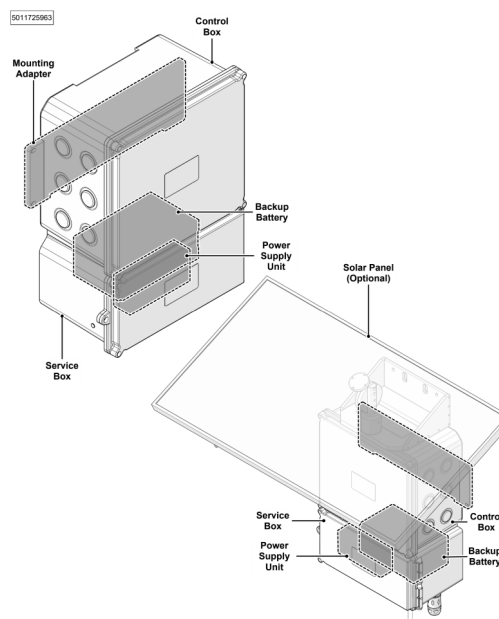

Figure 3-3: CAU - Physical Description



CAU-1